

2. Version mit Halteplatten / Version with fixing plates



BEDIENUNGSANLEITUNG INSTRUCTIONS

Messerwechsel / Blade exchange 12 40 200, 12 50 200

1. Version mit geschraubten Messern / *Version with bolted blades*
2. Version mit Halteplatten / *Version with fixing plates*

Page 1 - 3
Page 3 - 4

Vor Beginn aller Arbeiten Bedienungsanleitung lesen
Read these instructions completely before starting work



2.5



2.6



2.7

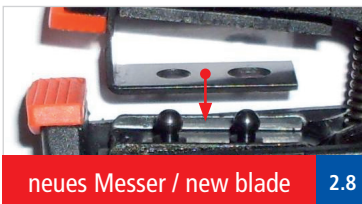

neues Messer / new blade

2.8

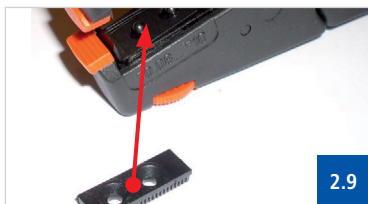

2.9



2.10



→ 2.4 ... 2.10 !

2.11



2.12



End



KNIPEX-Werk
C. Gustav Putsch KG
Oberkamper Straße 13
42349 Wuppertal / Germany
Tel: +49 (0) 202 - 47 94-0
info@knipex.de

1. Version mit geschraubten Messern / Version with bolted blades



1.1

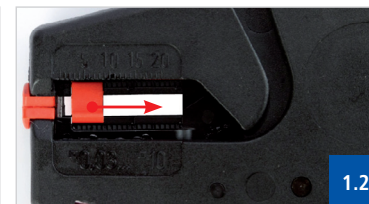

1.2

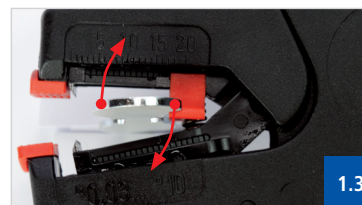

1.3

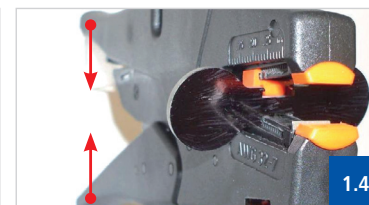

1.4

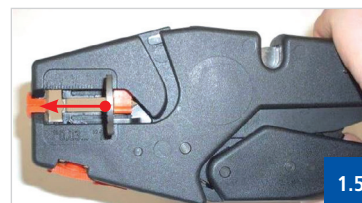

1.5



1.6